



# WINTER PARKING PERMIT APPLICATION

## PARKING AREA REVIEW

Property Owner's Name: \_\_\_\_\_ Date: \_\_\_\_\_

Authorized Representative's Name on behalf of the Property Owner: \_\_\_\_\_  
*(If applicable)*

Property Owner's Signature: \_\_\_\_\_  
*(The property owner **must** sign this form to authorize any representative on her/his behalf)*

Property Address \_\_\_\_\_ Phone Number: \_\_\_\_\_

Email Address \_\_\_\_\_ Number of Living Units: \_\_\_\_\_

Is the Property Grandfathered (if applicable): \_\_\_\_\_ Number of Tenants: \_\_\_\_\_

Current number of Parking Stalls on the Property (driveway, garage, parking lot, etc...): \_\_\_\_\_  
*(It is illegal to park on the park-strip, over the sidewalk or in the front yard)*

\_\_\_\_\_ Applicant acknowledges that any Parking Permit(s) issued by The City are non-refundable  
 (Initial)

Additional Comments/Info: \_\_\_\_\_  
*(Use diagram below or back side the paper if a drawing is needed)*

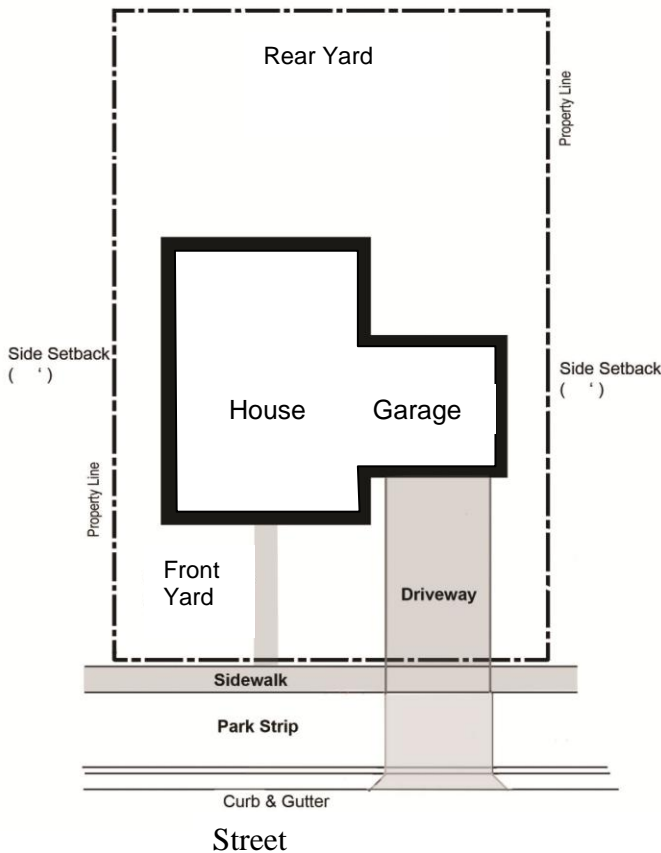

**Winter Parking Restriction**

10.52.170 (A) of the Municipal Code states:  
 "No person shall park a vehicle on any street or city owned parking lot between the hours of one o'clock (1:00) A.M. and six o'clock (6:00) A.M. of any day, beginning November 15 and ending the last day of February of each year."

A properly displayed Winter Parking Permit allows vehicles to be parked in on-street designated parking areas in the parallel position during winter nighttime hours.

**FOR STAFF USE ONLY**

Grandfathering Verification Y / N \_\_\_\_\_

Aerial Photo Property Review Y / N \_\_\_\_\_

Number of Permits Justified \_\_\_\_\_

Initial / Date \_\_\_\_\_

*Rental Properties will be charged \$50.<sup>00</sup>. Single Family Home permits will be issued at no charge*

Winter Parking Permit Application